

Ordering Code: **ML-3A2-X-Y 01-Z**

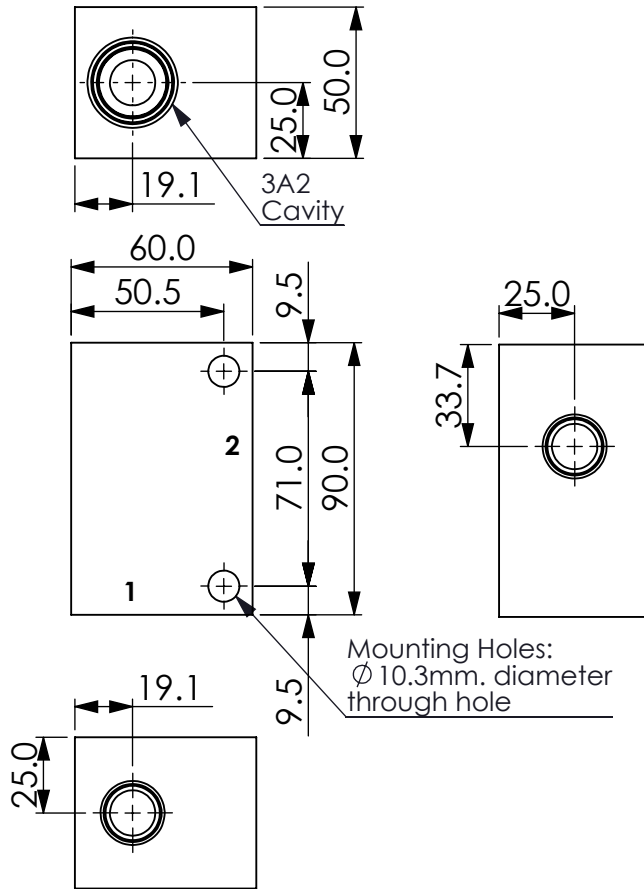

UNIT:mm

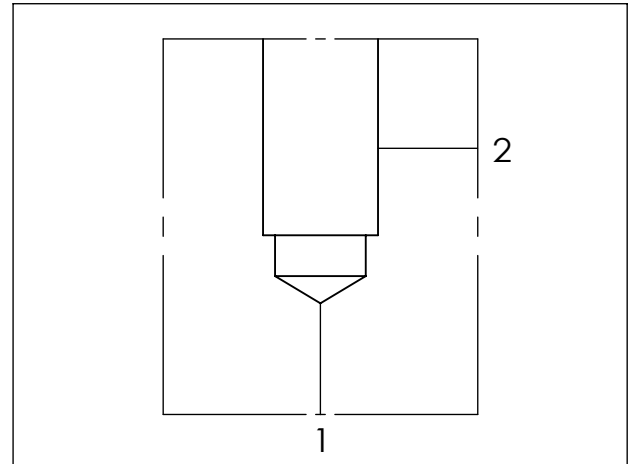

### TECHNICAL DATA

Aluminum Body Pressure Rating: 210 bar

Steel Body Pressure Rating: 350 bar

Cavity:

Refer to 3A2

\* Refer to Winner Cartridge Valves Catalog.

Aluminum	0.65 kg(WITHOUT VALVES)

\* If you need the special specification.  
Please contact us.

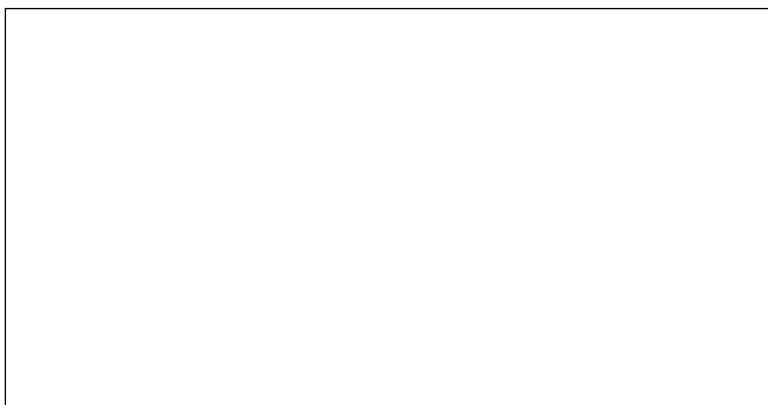

X	PORT SIZE		
	PORT 1	PORT 2	
	<b>A04</b>	1/2" NPT	
<b>P04</b>	1/2" PT	1/2" PT	

Y	BODY MATERIAL
<b>A</b>	HIGH-STRENGTH ALUMINUM

Z	CARTRIDGE VALVES SELECTION
	WITHOUT VALVE
<b>RPOA</b>	RP3A20AL(200 LPM,7~210 bar)
<b>RD5A</b>	RD3A25AL(200 LPM,35~210 bar)

Please refer to the list price of cartridge program.