

Ordering Code: **ML-10A2-X-Y 02-Z**

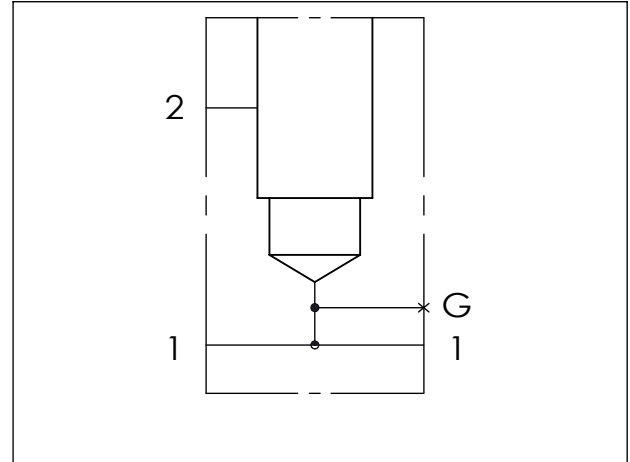
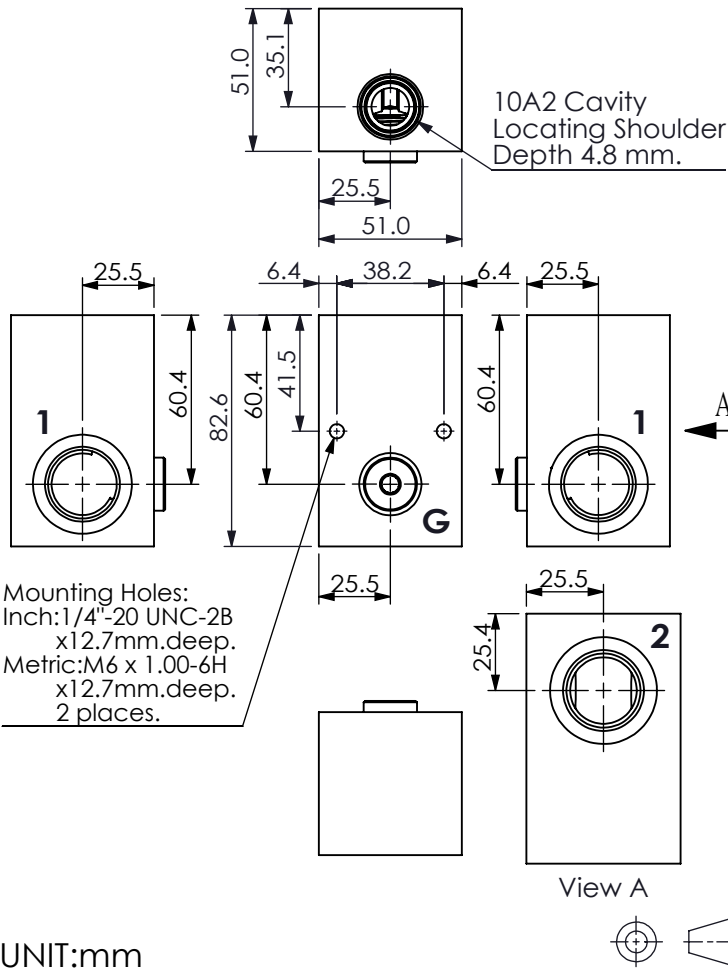

TECHNICAL DATA

Aluminum Body Pressure Rating: 210 bar
 Steel Body Pressure Rating: 350 bar

Cavity:

Refer to 10A2

* Refer to Winner Cartridge Valves Catalog.

Aluminum	0.45 kg(WITHOUT VALVES)
Steel	1.28 kg(WITHOUT VALVES)

* If you need the special specification. Please contact us.

X	PORT SIZE		
	PORTS	PORT	
	1,2	G	
G06G	G 3/4"	G 1/4"	

Y	BODY MATERIAL	
A	HIGH-STRENGTH ALUMINUM	
T	STEEL (black oxide)	

Z	CARTRIDGE VALVES SELECTION	
	WITHOUT VALVE	
RPOA	RP10A20AL(95 LPM,7~210 bar)	
RD5A	RD10A25AL(95 LPM,35~210 bar)	
	Please refer to the list price of cartridge program.	