

## LINE MOUNT BODIES

Ordering Code: **ML-11A3-X-Y 01-Z**

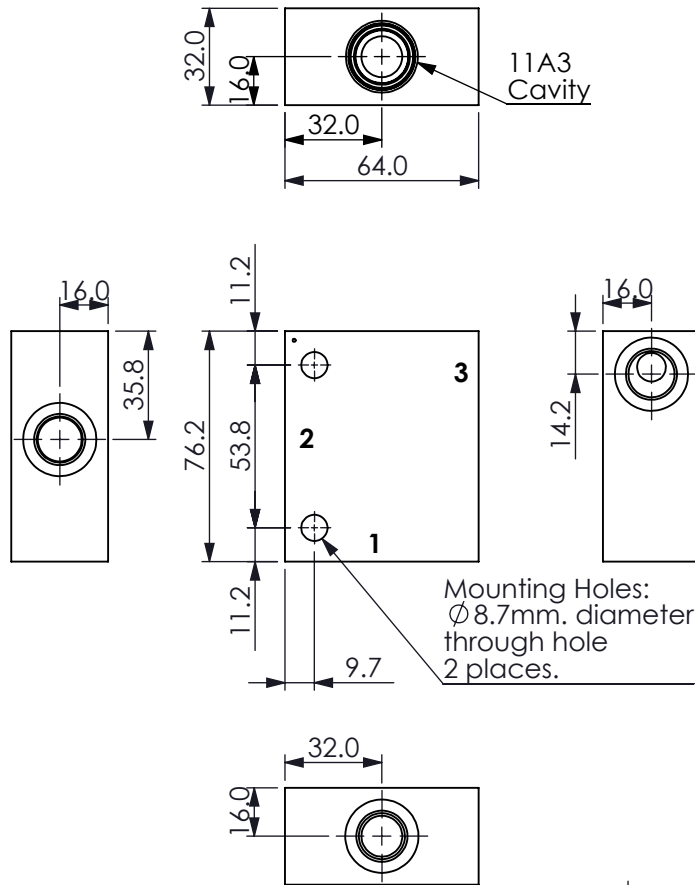

UNIT:mm

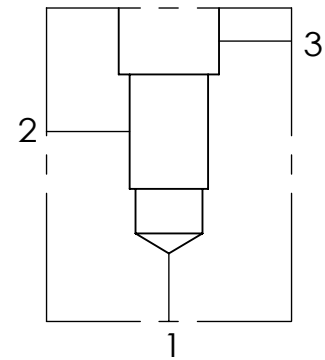
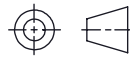

### TECHNICAL DATA

Aluminum Body Pressure Rating: 210 bar

Steel Body Pressure Rating: 350 bar

Cavity:

Refer to 11A3

\* Refer to Winner Cartridge Valves Catalog.

Aluminum	0.35 kg(WITHOUT VALVES)
Steel	0.95 kg(WITHOUT VALVES)

\* If you need the special specification.  
 Please contact us.

X	PORT SIZE		
	PORTS	PORT	
	1,2	3	
<b>G03</b>	G 3/8"	G 3/8"	
<b>G04B</b>	G 1/2"	G 3/8"	
<b>P03</b>	3/8"PT	3/8"PT	
<b>S08</b>	SAE 8	SAE 8	

Y	BODY MATERIAL	
<b>A</b>	HIGH-STRENGTH ALUMINUM	
<b>T</b>	STEEL (black oxide)	

If there are requirements for other materials or surface treatments, please contact the Winner sales department.

Z	CARTRIDGE VALVES SELECTION	
	WITHOUT VALVE	
<b>PPOA</b>	PP11A30AL (40LPM,7-210bar)	
<b>PDOA</b>	PD11A30AL (40LPM,35-210bar)	

Please refer to the list price of cartridge program.