

## LINE MOUNT BODIES

Ordering Code: **ML-163A3-X-Y 02-Z**

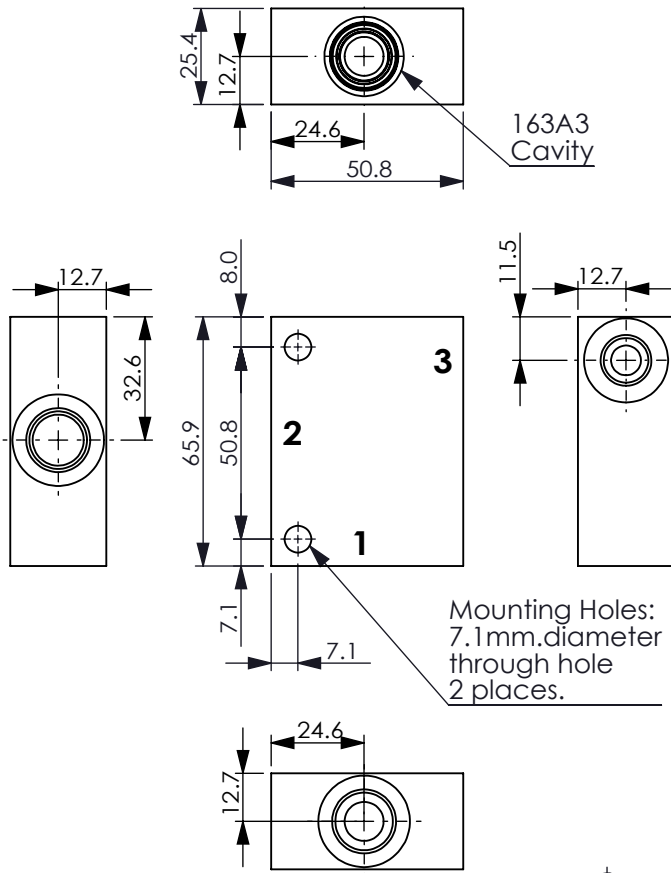

UNIT:mm

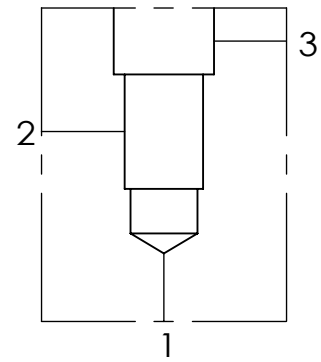

### TECHNICAL DATA

Aluminum Body Pressure Rating: 210 bar  
 Steel Body Pressure Rating: 350 bar

Cavity:

Refer to 163A3

\* Refer to Winner Cartridge Valves Catalog.

Aluminum	0.18 kg(WITHOUT VALVES)
Steel	0.52 kg(WITHOUT VALVES)

\* If you need the special specification. Please contact us.

### PORT SIZE

X	PORTS	PORT	
	1,2	3	
G03A	G 3/8"	G 1/4"	

### Y BODY MATERIAL

**A** HIGH-STRENGTH ALUMINUM

**T** STEEL (black oxide)

### Z CARTRIDGE VALVES SELECTION

WITHOUT VALVE