

LINE MOUNT BODIES

Ordering Code: **ML-163A3-X-Y 02-Z**

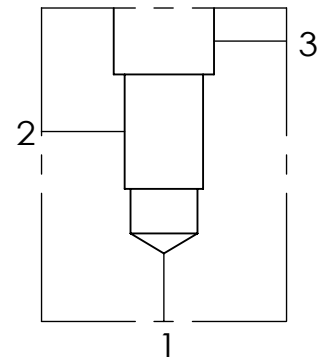
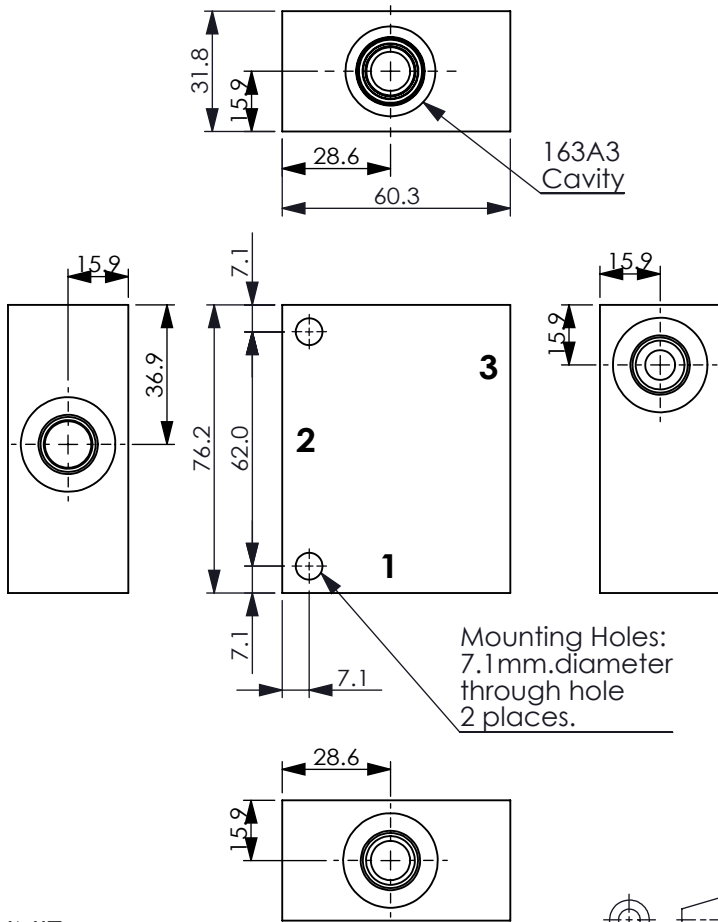

TECHNICAL DATA

Aluminum Body Pressure Rating: 210 bar
 Steel Body Pressure Rating: 350 bar

Cavity:

Refer to 163A3

* Refer to Winner Cartridge Valves Catalog.

Aluminum	0.33 kg(WITHOUT VALVES)

* If you need the special specification. Please contact us.

UNIT:mm

--	--

X	PORT SIZE		
	PORTS	PORT	
	1,2	3	
S06	SAE 6	SAE 6	

Y	BODY MATERIAL
A	HIGH-STRENGTH ALUMINUM

Z	CARTRIDGE VALVES SELECTION
	WITHOUT VALVE