

Ordering Code: **ML-17A3-X-Y 02-Z**

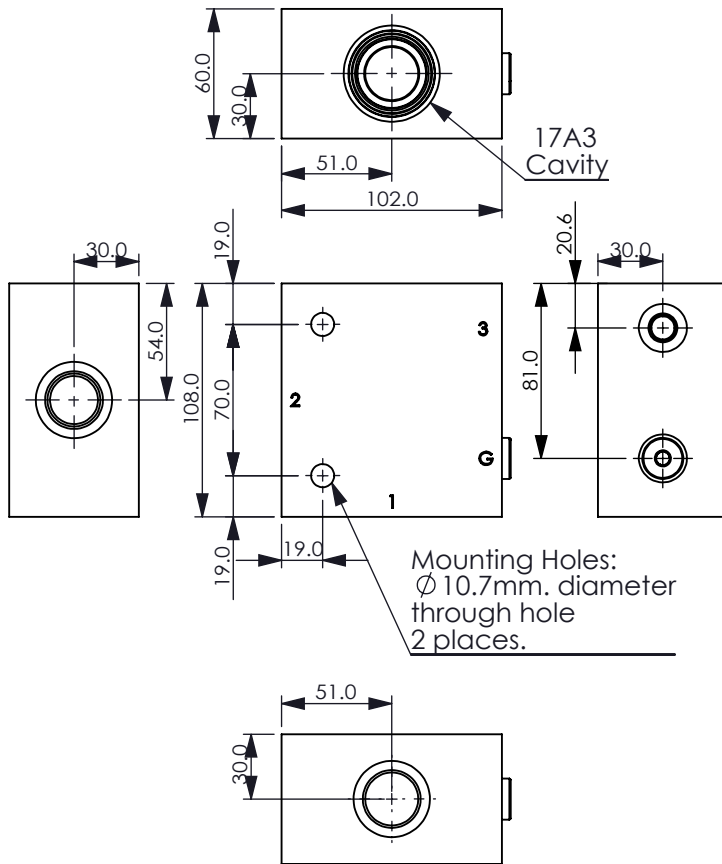

UNIT:mm

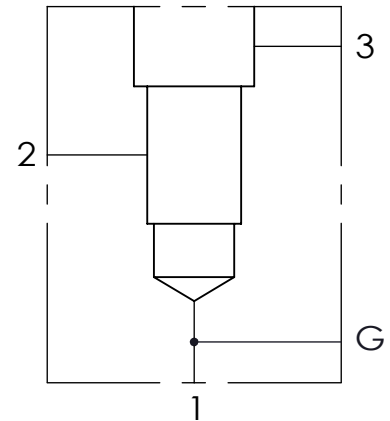

TECHNICAL DATA

Aluminum Body Pressure Rating: 210 bar

Steel Body Pressure Rating: 350 bar

Cavity:

Refer to 17A3

* Refer to Winner Cartridge Valves Catalog.

Aluminum	1.5 kg(WITHOUT VALVES)
Steel	4.2 kg(WITHOUT VALVES)

* If you need the special specification. Please contact us.

PORT SIZE

X	PORTS		
	1,2	3	G
G06AG	G 3/4"	G1/4"	G1/4"
G08BG	G 1"	G3/4"	G1/4"
S16AG	SAE 16	SAE 12	1/4"NPT

Y BODY MATERIAL

A HIGH-STRENGTH ALUMINUM

T STEEL (black oxide)

Z CARTRIDGE VALVES SELECTION

WITHOUT VALVE

RV0A RV17A30AL (240LPM,7-210bar)

CBCH CB17A3CHL (3:1,70-280bar)

CO20 CO17A3020N (240LPM,2.0bar)

CC20 CC17A3020N (320LPM,2.0bar)

PB0A PB17A30AL (160LPM,7-210bar)

Please refer to the list price of cartridge program.