

Ordering Code: **ML-22A4-X-Y 01-Z**

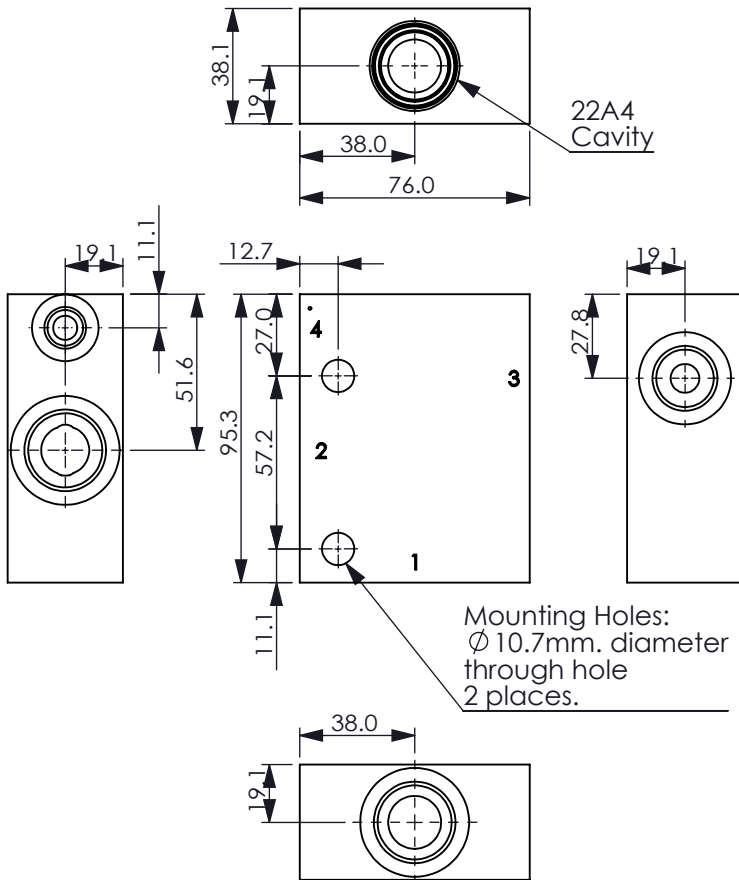

Mounting Holes:
 $\varnothing 10.7$ mm. diameter
 through hole
 2 places.

UNIT:mm

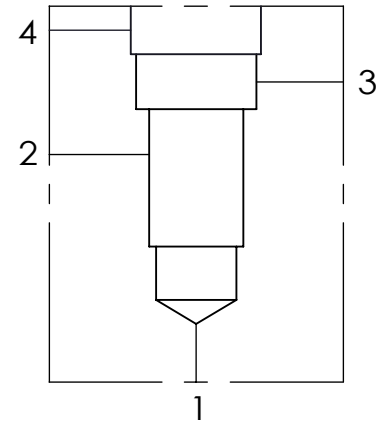

TECHNICAL DATA

Aluminum Body Pressure Rating: 210 bar

Steel Body Pressure Rating: 350 bar

Cavity:

Refer to 22A4

* Refer to Winner Cartridge Valves Catalog.

Aluminum	0.56 kg(WITHOUT VALVES)
----------	-------------------------

Steel	1.52 kg(WITHOUT VALVES)
-------	-------------------------

* If you need the special specification.
 Please contact us.

X	PORT SIZE		
	PORTS	PORT	PORT
	1,2	3	4
G03A	G 3/8"	G 3/8"	G 1/4"
G04A	G 1/2"	G 1/2"	G 1/4"
G06CA	G 3/4"	G 1/2"	G 1/4"
S08A	SAE 8	SAE 8	SAE 6
S12A	SAE 12	SAE 10	SAE 6

Y	BODY MATERIAL
A	HIGH-STRENGTH ALUMINUM
T	STEEL (black oxide)

Z	CARTRIDGE VALVES SELECTION
	WITHOUT VALVE
PV0A	PV22A40AL (80LPM,7-210bar)

Please refer to the list price of cartridge program.