

Ordering Code: **ML-23A4-X-Y 01-Z**

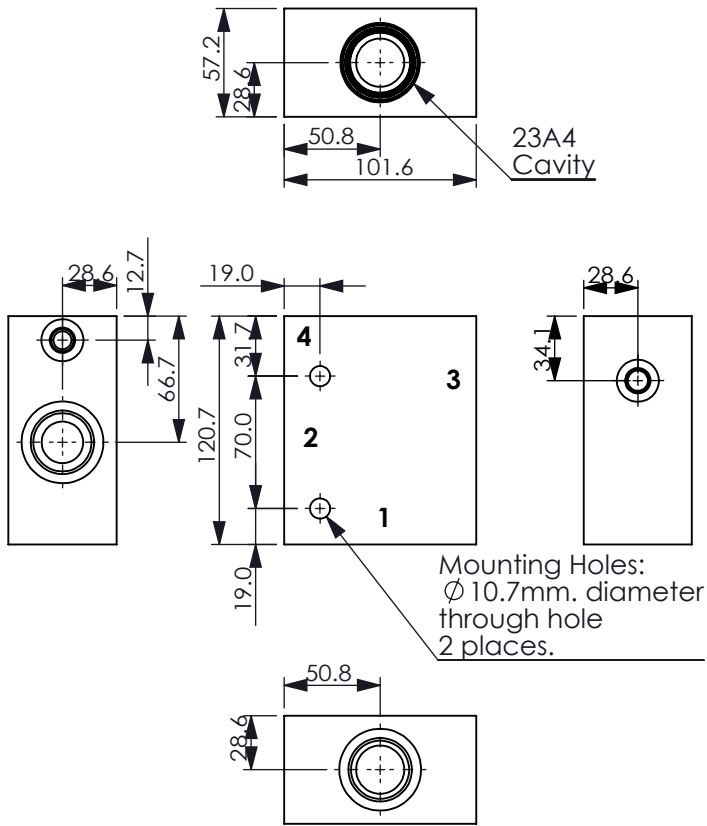

UNIT:mm

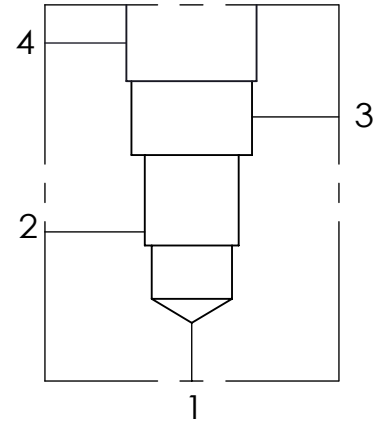

TECHNICAL DATA

Aluminum Body Pressure Rating: 210 bar

Steel Body Pressure Rating: 350 bar

Cavity:

Refer to 23A4

* Refer to Winner Cartridge Valves Catalog.

Aluminum	1.47 kg(WITHOUT VALVES)
Steel	4.29 kg(WITHOUT VALVES)

* If you need the special specification.
 Please contact us.

X	PORT SIZE		
	PORTS	PORTS	
	1,2	3,4	
G08A	G 1"	G 1/4"	

Y	BODY MATERIAL	
A	HIGH-STRENGTH ALUMINUM	
T	STEEL (black oxide)	

Z	CARTRIDGE VALVES SELECTION	
	WITHOUT VALVE	
PV0A	PV23A40AL (160LPM,7-210bar)	

Please refer to the list price of cartridge program.