

Ordering Code: **ML-31A4-X-Y 01-Z**

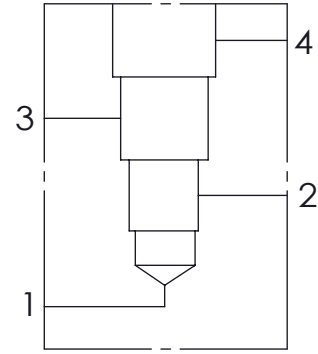
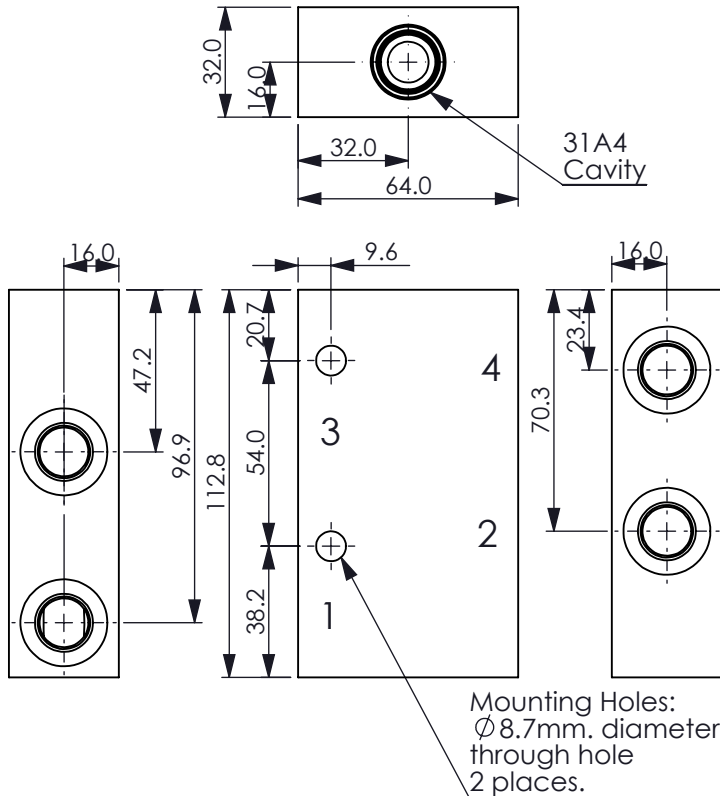

### TECHNICAL DATA

Aluminum Body Pressure Rating: 210 bar  
 Steel Body Pressure Rating: 350 bar

Cavity:

Refer to 31A4

\* Refer to Winner Cartridge Valves Catalog.

Aluminum	0.55 kg(WITHOUT VALVES)
Steel	1.45 kg(WITHOUT VALVES)

\* If you need the special specification.  
 Please contact us.

UNIT:mm

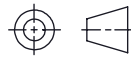

### PORT SIZE

X	PORTS		
	1,2	3,4	
<b>G02</b>	G 1/4"	G 1/4"	
<b>G03</b>	G 3/8"	G 3/8"	
<b>G04</b>	G 1/2"	G 1/2"	
<b>S06</b>	SAE 6	SAE 6	

### Y BODY MATERIAL

**A** HIGH-STRENGTH ALUMINUM

**T** STEEL (black oxide)

### Z CARTRIDGE VALVES SELECTION

WITHOUT VALVE