

Ordering Code: **ML-32A4-X-Y 11-Z**

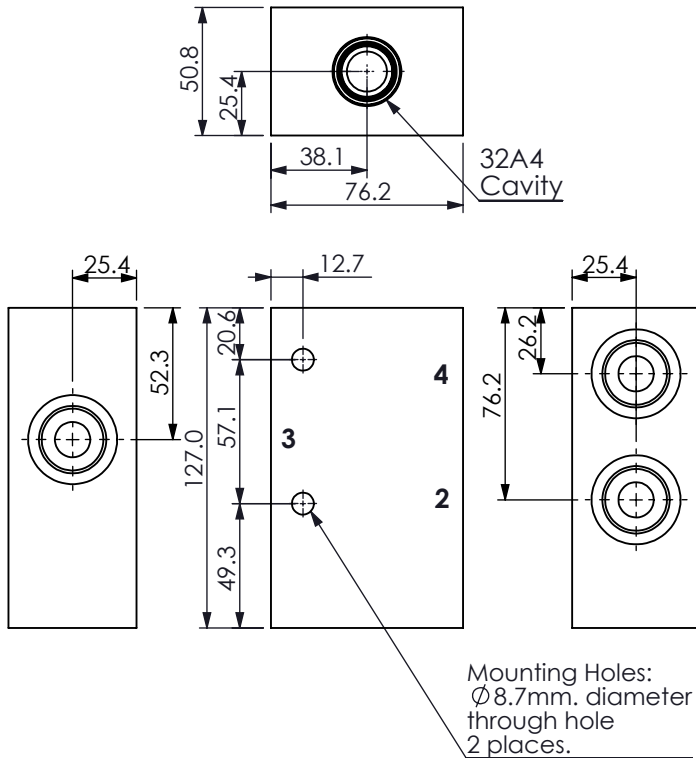

UNIT:mm

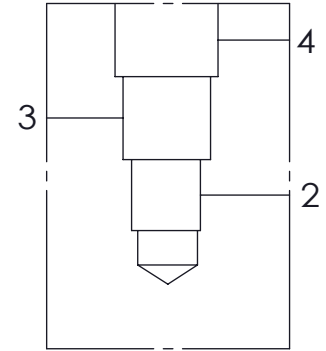
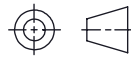

### TECHNICAL DATA

Aluminum Body Pressure Rating: 210 bar  
 Steel Body Pressure Rating: 350 bar

Cavity:

Refer to 32A4

\* Refer to Winner Cartridge Valves Catalog.

Aluminum	1.1 kg(WITHOUT VALVES)
Steel	3.05 kg(WITHOUT VALVES)

\* If you need the special specification. Please contact us.

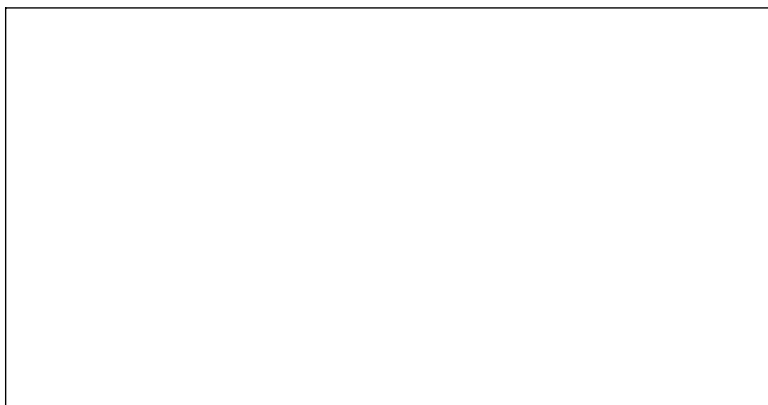

### PORT SIZE

X	PORT SIZE		
	PORT	PORTS	
	<b>3</b>	<b>2,4</b>	
<b>G04</b>	G 1/2"	G 1/2"	
<b>G06</b>	G 3/4"	G 3/4"	
<b>S08</b>	SAE 8	SAE 8	
<b>S10</b>	SAE 10	SAE 10	
<b>S12</b>	SAE 12	SAE 12	

Y	BODY MATERIAL	
<b>A</b>	<b>HIGH-STRENGTH ALUMINUM</b>	
<b>T</b>	<b>STEEL (black oxide)</b>	

### Z CARTRIDGE VALVES SELECTION

WITHOUT VALVE