

Ordering Code: **ML-22M2-X-Y 01-Z**

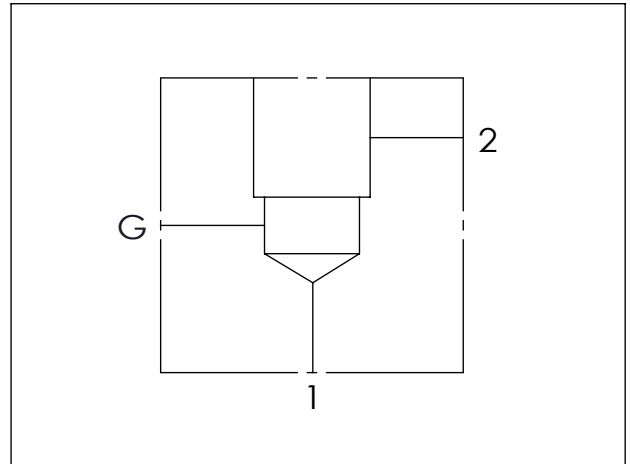
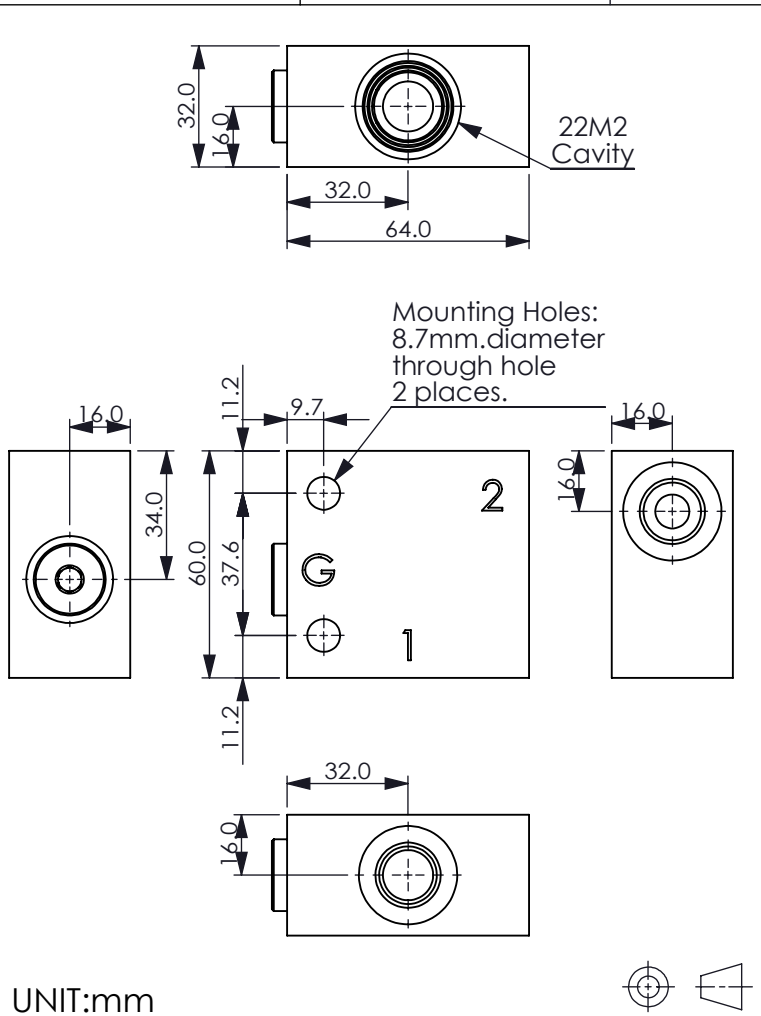

### TECHNICAL DATA

Aluminum Body Pressure Rating: 210 bar

Steel Body Pressure Rating: 350 bar

Cavity:

Refer to 22M2

\* Refer to Winner Cartridge Valves Catalog.

|          |                         |
|----------|-------------------------|
| Aluminum | 0.28 kg(WITHOUT VALVES) |
| Steel    | 0.78 kg(WITHOUT VALVES) |

\* If you need the special specification. Please contact us.

| X           | PORT SIZE |        |  |
|-------------|-----------|--------|--|
|             | PORTS     | PORT   |  |
|             | 1,2       | G      |  |
| <b>G03G</b> | G 3/8"    | G 1/4" |  |

| Y        | BODY MATERIAL          |  |
|----------|------------------------|--|
| <b>A</b> | HIGH-STRENGTH ALUMINUM |  |
| <b>T</b> | STEEL (black oxide)    |  |

| Z | CARTRIDGE VALVES SELECTION |
|---|----------------------------|
|   | WITHOUT VALVE              |