

Ordering Code: **ML-28M2-X-Y 01-Z**

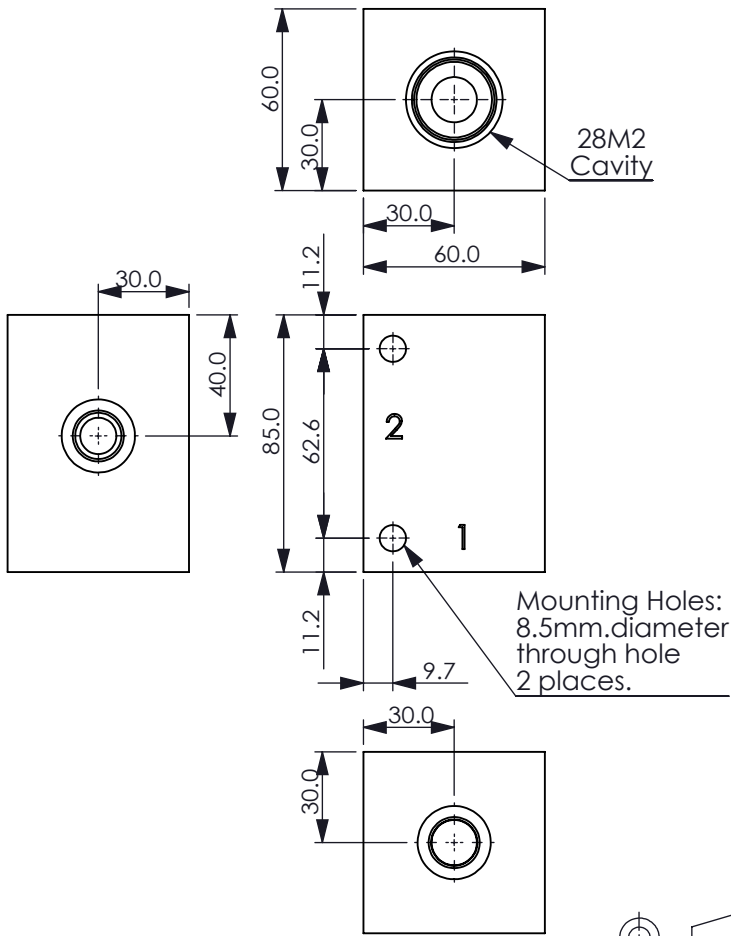

UNIT:mm

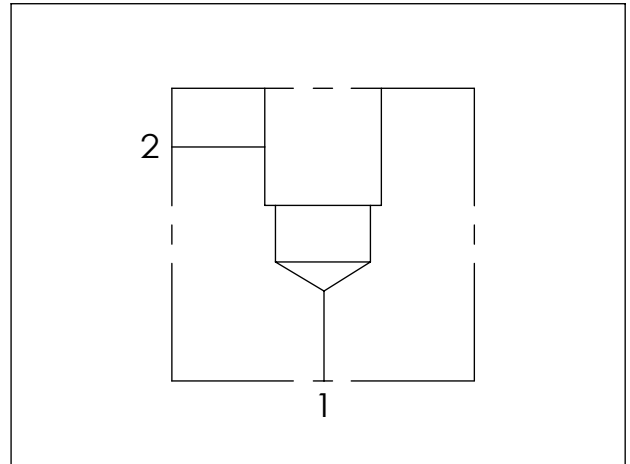

TECHNICAL DATA

Aluminum Body Pressure Rating: 210 bar

Steel Body Pressure Rating: 350 bar

Cavity:

Refer to 28M2

* Refer to Winner Cartridge Valves Catalog.

Aluminum	0.71 kg(WITHOUT VALVES)
Steel	2.15 kg(WITHOUT VALVES)

* If you need the special specification. Please contact us.

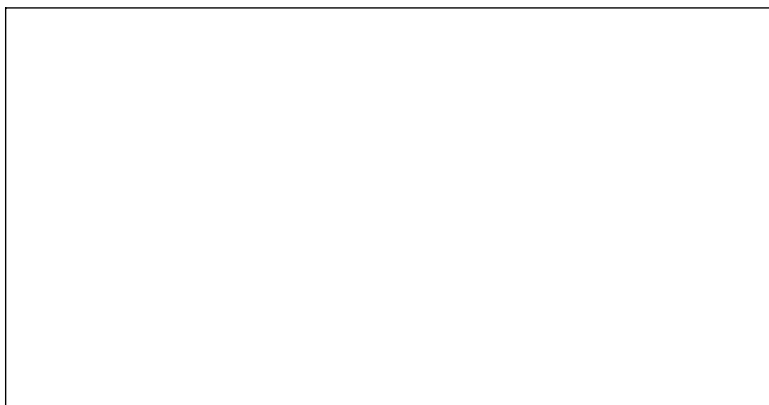

X	PORT SIZE		
	PORT	PORT	
	1	2	
G03	G 3/8"	G 3/8"	

Y	BODY MATERIAL	
A	HIGH-STRENGTH ALUMINUM	
T	STEEL (black oxide)	

Z	CARTRIDGE VALVES SELECTION
	WITHOUT VALVE