

Ordering Code: **ML-08W2-X-Y 01-Z**

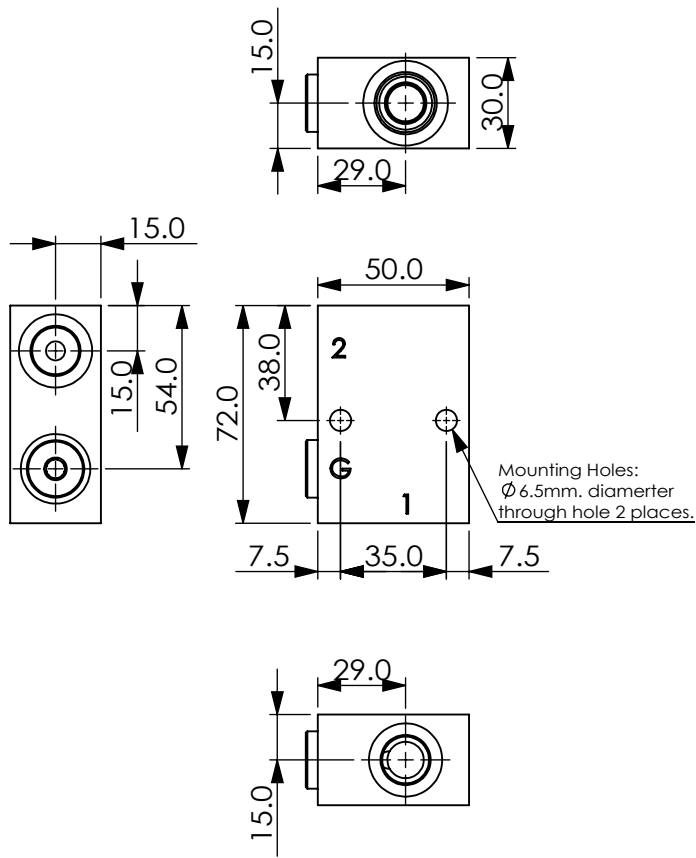

UNIT:mm

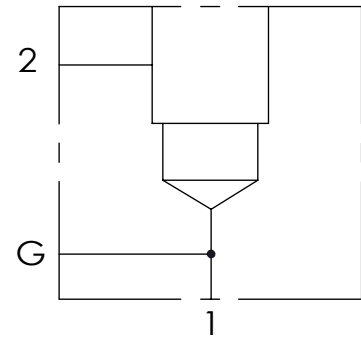

TECHNICAL DATA

Aluminum Body Pressure Rating: 210 bar

Steel Body Pressure Rating: 350 bar

Cavity:

Refer to 08W2

* Refer to Winner Cartridge Valves Catalog.

Aluminum	0.25 kg(WITHOUT VALVES)
Steel	0.7 kg(WITHOUT VALVES)

* If you need the special specification. Please contact us.

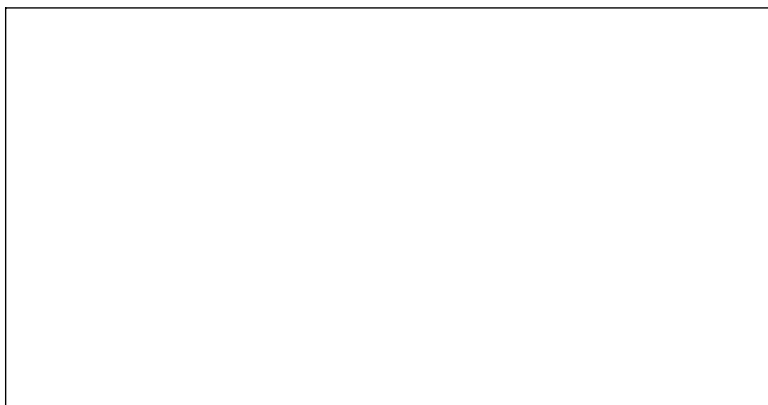

X	PORT SIZE		
	PORTS	PORT	
	1,2	G	
G03G	G 3/8"	G 1/4"	

Y	BODY MATERIAL	
A	HIGH-STRENGTH ALUMINUM	
T	STEEL (black oxide)	

Z	CARTRIDGE VALVES SELECTION	
	WITHOUT VALVE	
RD0A	RD08W20AL(20LPM,80-210bar)	
CV2003	CV08W2003N (30LPM,0.3bar)	
NV0N	NV08W20NL (350bar)	
NC0N	NC08W20NL (350bar)	
EP01	EP08W2A01N05 , 40LPM,350bar (NORMALLY CLOSED,WITHOUT COIL)	
EP02	EP08W2A02N05 , 40LPM,350bar (NORMALLY OPEN,WITHOUT COIL)	
	COIL MUST BE ORDERED SEPARATELY (REFER TO EC-04W-X-Y-Z)	