

Ordering Code: **ML-10W3-X-Y 01-Z**

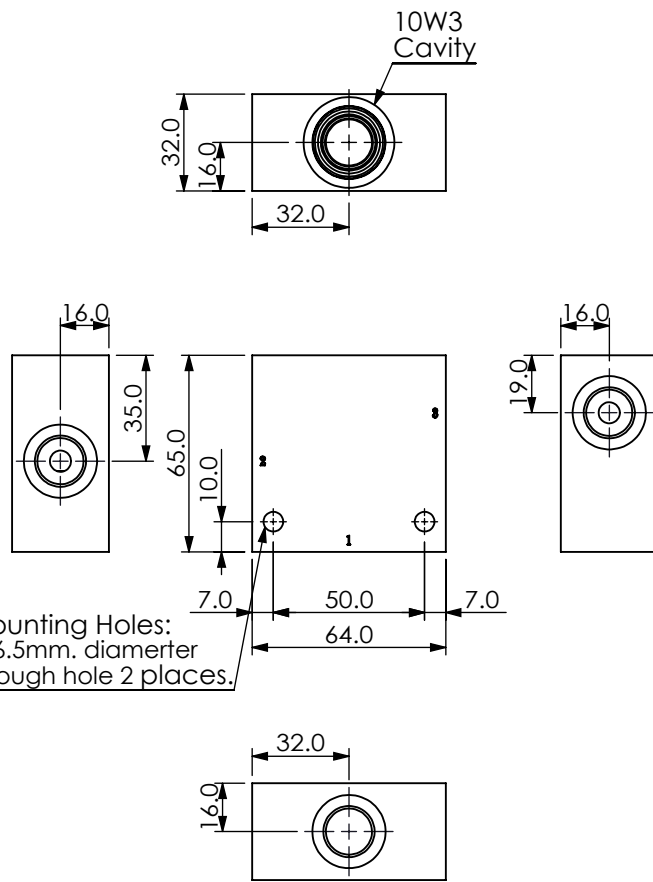

UNIT:mm

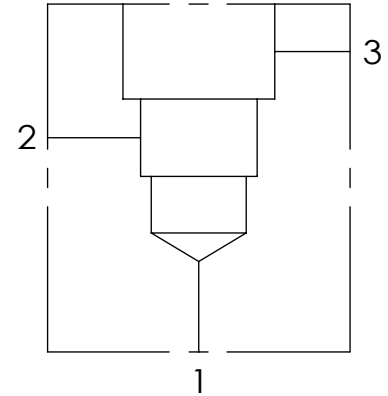

TECHNICAL DATA

Aluminum Body Pressure Rating: 210 bar

Steel Body Pressure Rating: 350 bar

Cavity:

Refer to 10W3

* Refer to Winner Cartridge Valve Catalog.

Aluminum	0.3 kg(WITHOUT VALVES)
----------	------------------------

Steel	0.92 kg(WITHOUT VALVES)
-------	-------------------------

* If you need the special specification.
Please contact us.

PORT SIZE

X	PORTS		
	1,2	3	
G03	G 3/8"	G 3/8"	
P03	3/8" PT	3/8" PT	
S06	SAE 6	SAE 6	

Y BODY MATERIAL

A HIGH-STRENGTH ALUMINUM

T STEEL (black oxide)

Z CARTRIDGE VALVES SELECTION

WITHOUT VALVE

FR1L FR10W31NL(13LPM,240bar)

FR3L FR10W33NL(38LPM,240bar)

Please refer to the list price of cartridge program.