

Ordering Code: **ML-10WB3-X-Y 01-Z**

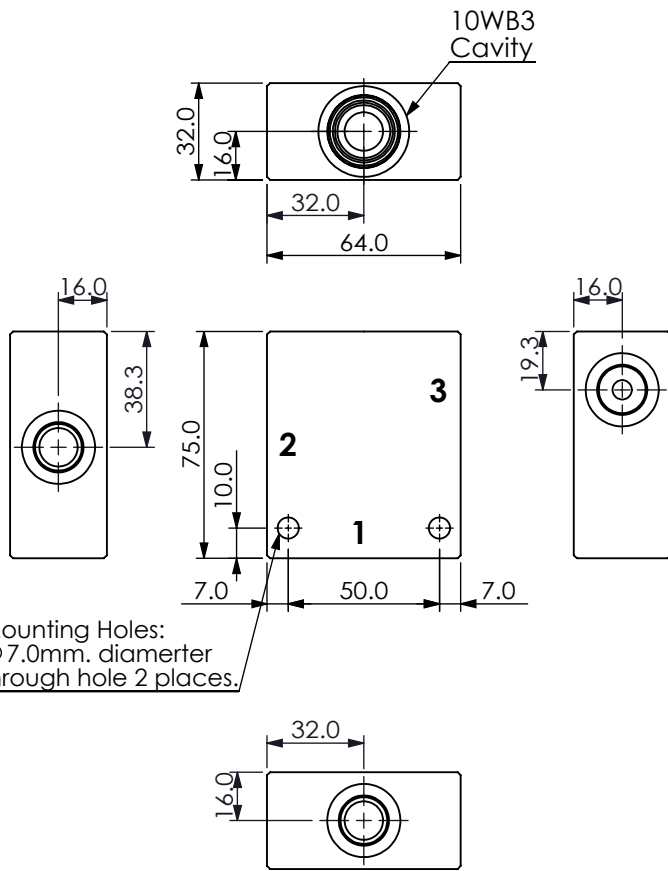

UNIT:mm

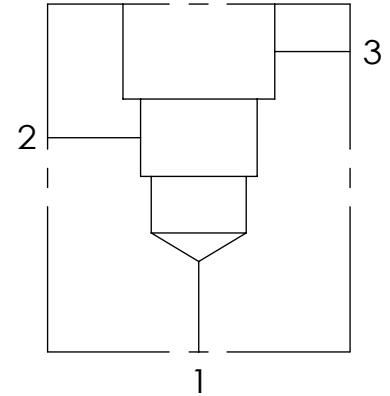

TECHNICAL DATA

Aluminum Body Pressure Rating: 210 bar

Steel Body Pressure Rating: 350 bar

Cavity:

Refer to 10WB3

* Refer to Winner Cartridge Valve Catalog.

Aluminum	0.33 kg(WITHOUT VALVES)
----------	-------------------------

* If you need the special specification.
Please contact us.

PORT SIZE

X	PORTS	PORT	
	1,2	3	
G03	G 3/8"	G 3/8"	

Y BODY MATERIAL

A HIGH-STRENGTH ALUMINUM

Z CARTRIDGE VALVES SELECTION

WITHOUT VALVE