

Ordering Code: **ML-12W2-X-Y 41-Z**

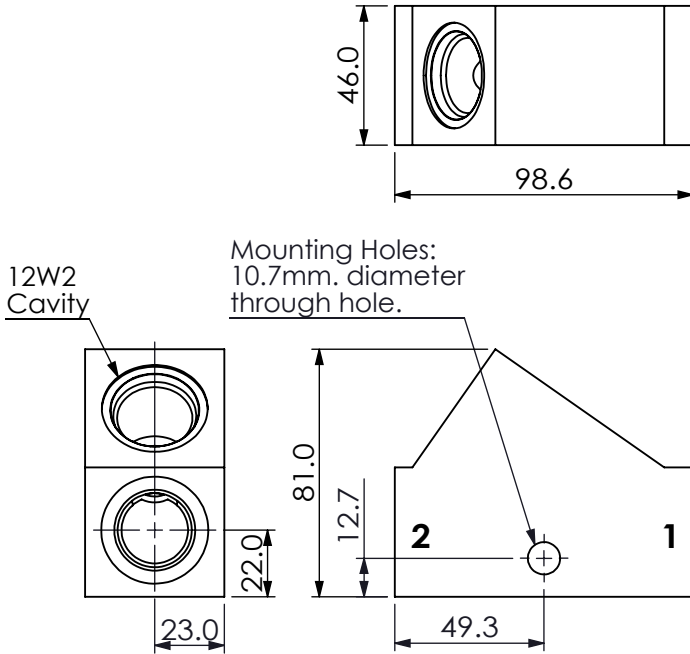

UNIT:mm

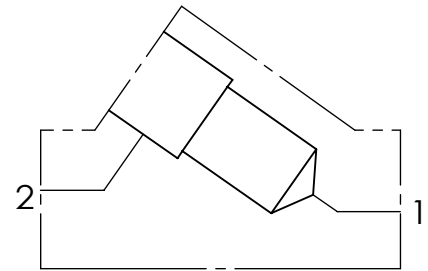

### TECHNICAL DATA

Aluminum Body Pressure Rating: 210 bar  
 Ductile Iron Body Pressure Rating: 350 bar

Cavity:

Refer to 12W2

\* Refer to Winner Cartridge Valves Catalog.

Aluminum	0.55 kg(WITHOUT VALVES)
Ductile Iron	1.62 kg(WITHOUT VALVES)

\* If you need the special specification. Please contact us.

### PORT SIZE

X	PORT	PORT	
	1	2	
<b>G06</b>	G 3/4"	G 3/4"	

### Y BODY MATERIAL

**A HIGH-STRENGTH ALUMINUM**

**S DUCTILE IRON**

### Z CARTRIDGE VALVES SELECTION

WITHOUT VALVE

**CV2003** CV12W2003N (90LPM,0.3bar)

**NV0N** NV12W20NL (350bar)

**EP01** EP12W2A01N05 , 150LPM,350bar (NORMALLY CLOSED,WITHOUT COIL)

**EP02** EP12W2A02N05 , 150LPM,350bar (NORMALLY OPEN,WITHOUT COIL)

COIL MUST BE ORDERED SEPARATELY (REFER TO EC-04W-X-Y-Z)