

Ordering Code: **ML-16WC3-X-Y01-Z**

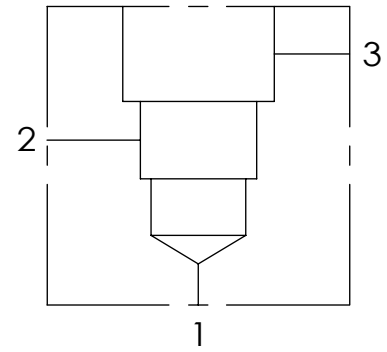
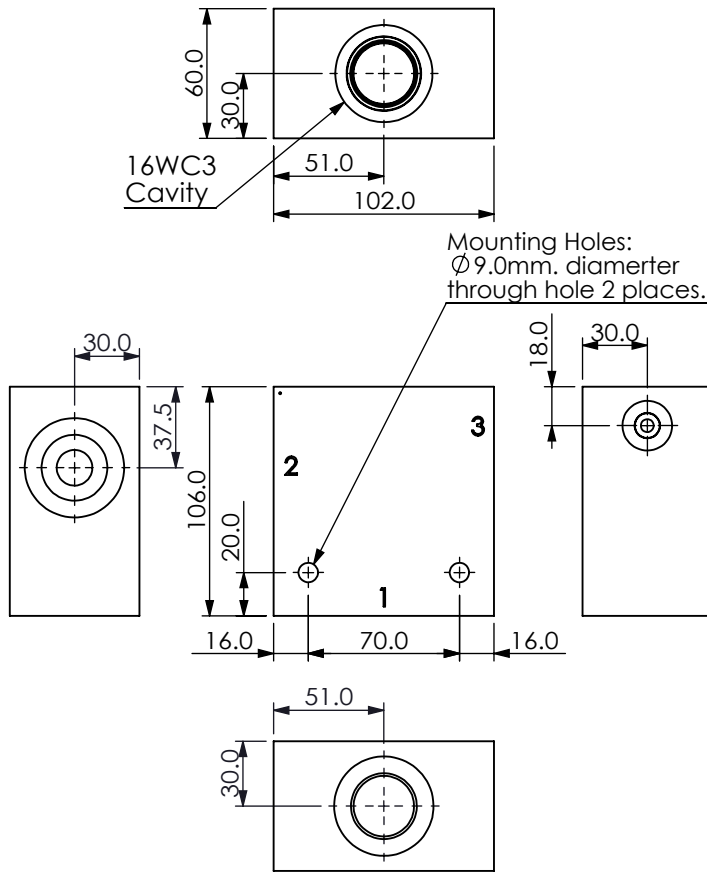

### TECHNICAL DATA

Aluminum Body Pressure Rating: 210 bar

Steel Body Pressure Rating: 350 bar

Cavity:

Refer to 16WC3

\* Refer to Winner Cartridge Valves Catalog.

Aluminum	1.45 kg(WITHOUT VALVES)
----------	-------------------------

\* If you need the special specification. Please contact us.

X	PORT SIZE		
	PORTS	PORT	
	1,2	3	
G08A	G 1"	G 1/4"	

Y	BODY MATERIAL
A	HIGH-STRENGTH ALUMINUM

Z	CARTRIDGE VALVES SELECTION
	WITHOUT VALVE