

Ordering Code: **ML-20WB2-X-Y 01-Z**

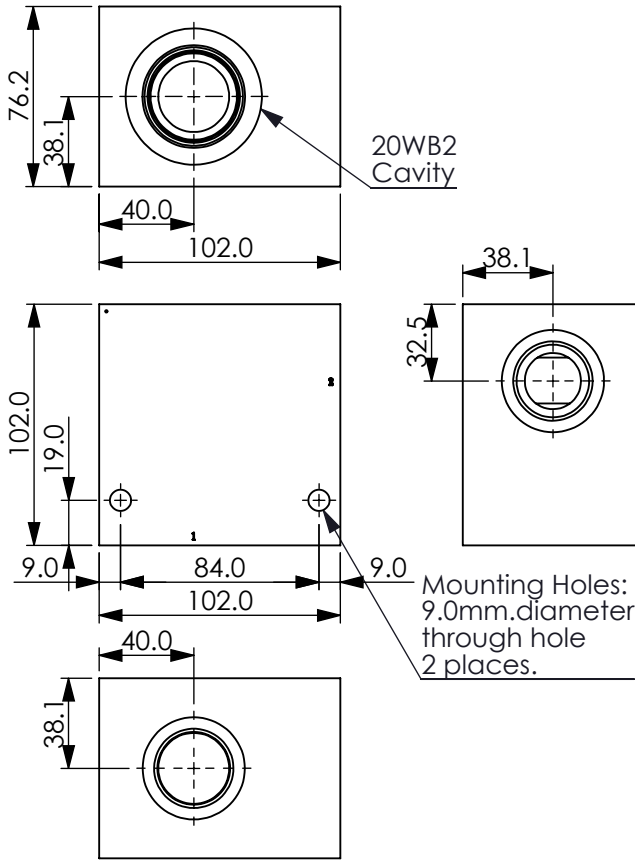

UNIT:mm

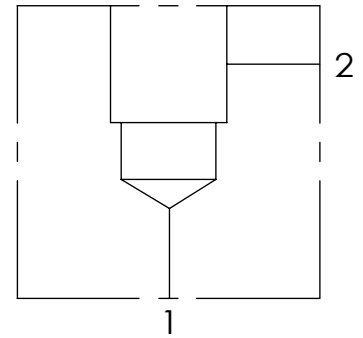

TECHNICAL DATA

Aluminum Body Pressure Rating: 210 bar
 Steel Body Pressure Rating: 350 bar

Cavity:

Refer to 20WB2

* Refer to Winner Cartridge Valves Catalog.

Aluminum	1.73 kg(WITHOUT VALVES)
Steel	5.07 kg(WITHOUT VALVES)

* If you need the special specification. Please contact us.

PORT SIZE

X	PORT		
	1	2	
G08	G 1"	G 1"	

Y BODY MATERIAL

A HIGH-STRENGTH ALUMINUM

T STEEL (black oxide)

Z CARTRIDGE VALVES SELECTION

WITHOUT VALVE