

Ordering Code: **ML-20WS3-X-Y 01-Z**

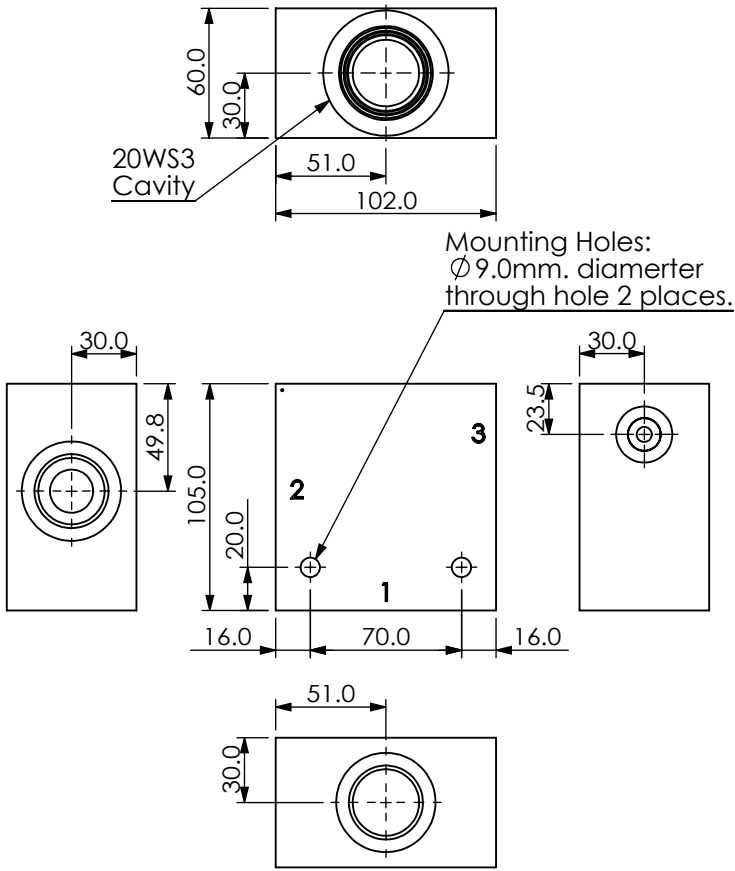

UNIT:mm

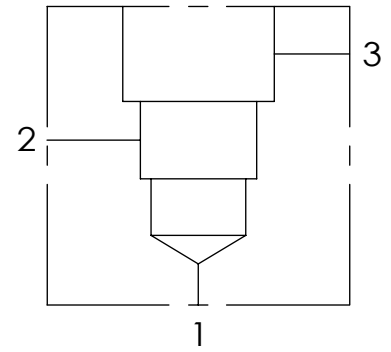

TECHNICAL DATA

Aluminum Body Pressure Rating: 210 bar

Steel Body Pressure Rating: 350 bar

Cavity:

Refer to 20WS3

* Refer to Winner Cartridge Valves Catalog.

Aluminum	1.35 kg(WITHOUT VALVES)

* If you need the special specification.
 Please contact us.

PORT SIZE

X	PORTS	PORT	
	1,2	3	
G08A	G 1"	G 3/8"	

Y BODY MATERIAL

A HIGH-STRENGTH ALUMINUM

Z CARTRIDGE VALVES SELECTION

WITHOUT VALVE